



PAC INTERNATIONAL, INC.



RSIC-1 SOUND ISOLATION CLIP

RSIC-1

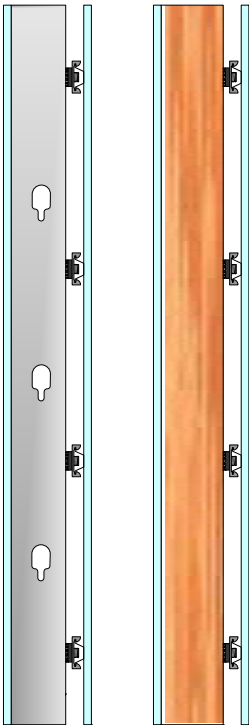

The **RSIC-1** is designed for use with any wood framed, steel framed, CMU, or concrete wall and ceiling system where noise control is needed. The RSIC-1 assembly decouples and isolates the gypsum board or plywood from the structure increasing the acoustical performance of the system. With an Acoustical design load rating of 36 lbs per isolator, the RSIC-1 clip can support up to two layers of 5/8" gypsum board when spaced at 24" x 48" oc. For heavier systems increase the number of isolators to support the additional weight of the system. The RSIC-1 clip fastens directly to the framing or structure creating a 1-5/8" cavity between the face of the framing and the back of the gypsum board. The RSIC-1 stops the noise and vibrations that typically would be allowed to transfer through the structure. The RSIC-1 systems have several UL fire resistive design assemblies from ranging one hour to four hours. The UL assemblies can be viewed on our site at http://pac-intl.com/fire_ratings_list.html, and on UL.com

RSIC-1, the Low Cost, High Performance, Noise control Solution

| |
|------------|
| Wood |
| Steel |
| Metal deck |

| |
|------------|
| Concrete |
| Condo |
| Commercial |

| |
|------------------|
| Apartment |
| Retail |
| Conference Rooms |

| |
|--------------------|
| Recording Studio |
| Home Theater |
| Commercial theater |

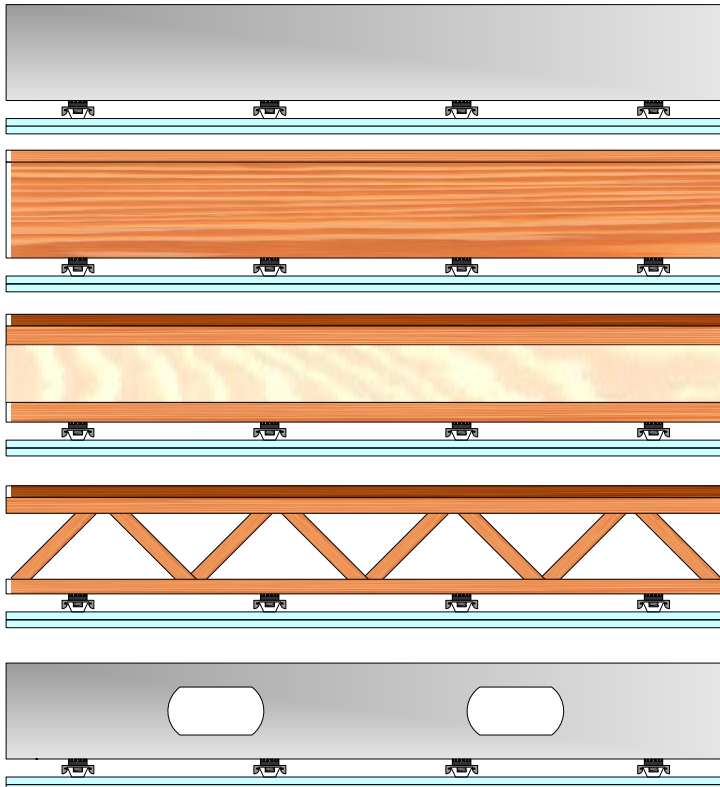

RSIC-1 specifications:

| | |
|----------------------------|--------------|
| Acoustical design load: | 36 Lbs |
| Total deflection | 3 mm |
| Double deflection | Yes (1.5 mm) |
| Made in the USA | Yes |
| Made with Recycled content | Yes |
| Low VOC treated | Yes |
| Adjustable | No |
| Cavity min | 1-5/8" |
| Cavity Max | 1-5/8" |
| Adjustment limit | N/A |
| Use on Ceilings | Yes |
| Use on walls | Yes |
| New Construction | Yes |
| Retro Fit | Yes |

DISTRIBUTOR SOUND [ISOLATION] COMPANY 888-666-5090

RSIC-1 INSTALLATION GUIDE

RSIC-1 SOUND ISOLATION CLIP



RSIC-1



RSIC-1 SOUND ISOLATION CLIP

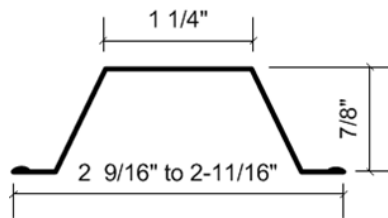

Drywall Furring Channel:

- **Recommended:** 25 gauge, hemmed edge detail required on all 25 gauge furring channel. Meets or exceeds SFIA requirements.
- **Depth:** 7/8 inch
- **Width Bottom:** 2-9/16" to 2-11/16" inch wide nominal.
- **Width Top:** 1-1/4 inch wide

Splice drywall furring channel (hat track) with 6 inch overlap in mid span (between two clips) secure with 18 ga tie wire, or two 7/16" framing screws.



Resilient Sound Isolation Clip (RSIC-1)

- **Maximum Spacing:** 48 inches on center
- **Maximum Acoustical Design Load:** 36 lbs

Fasteners:

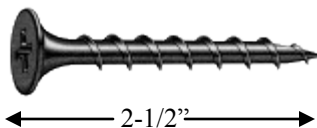

2-1/2"

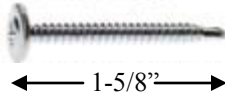

1-5/8"

- **RSIC-1 to Wood:** #8 x 2-1/2 inch minimum size coarse thread screw. (Recommended #12 or #10 x 2-1/2 inch hex head)
- **RSIC-1 to Steel:** # 8 x 1-5/8 inch minimum size fine thread screw. (Recommended #12 or #10 x 1-5/8 inch hex head)
- DO NOT fasten Resilient Sound Isolation Clips (RSIC-1) to framing members with nails. Use only approved screws.

RSIC-1 Dimensions:

- RSIC-1 clip 3" tall
- RSIC-1 clip 1-1/4" deep
- RSIC-1 and drywall furring channel 1-5/8" deep

Average Labor Rates:

- **RSIC-1:** 72 clips per man hour
- **Drywall Furring Channel:** 550LF per man hour

Labor rates provided to PAC International, Inc by an independent contracting firm.

888-666-5090

www.soundisolationcompany.com sales@soundisolationcompany.com

RSIC® is a registered Trademark of PAC International, Inc.

RSIC-1 SOUND ISOLATION CLIP

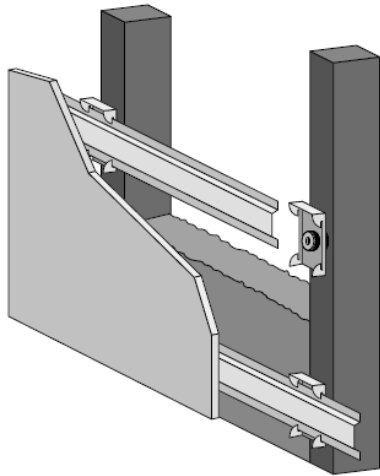

WALLS: One and Two Layers of 5/8" Gypsum Board

- Resilient Sound Isolation Clips (RSIC-1) shall be 48 inches maximum on center (horizontal).
- Fasten the Resilient Sound Isolation Clip (RSIC-1) to the substrate with a fastener approved for a minimum pull-out and shear of 120 lbs.
- Ensure the internal metal ferrule is tight to the substrate. • Locate the first row of RSIC-1 clips within 3 inches from the floor and within 6 inches from the ceiling.
- Snap in the drywall furring channel (hat track) into the RSIC-1 clips (horizontal for walls). (see page 2 for splice details)
- Place 1/4" (minimum) shim on floor to fully support the gypsum board.
- Install the gypsum board from the bottom up leaving a 1/4" min. gap around the perimeter of the wall.
- ONLY remove the shims after ALL the gypsum board is completely screwed to ALL the drywall furring channels. Make sure every screw (floor to ceiling and wall to wall) is installed as required by the assembly design, in every layer of gypsum board before removing the shims at the floor. The shims are critical to ensure best results.
- Caulk around the entire perimeter of the gypsum board. Use fire and smoke rated acoustical sealant where required.

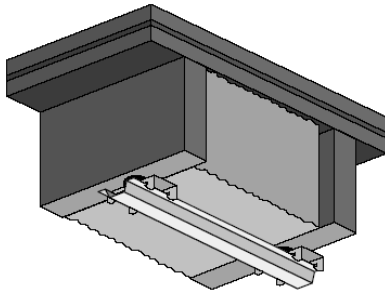

Ceilings: One and Two Layers of 5/8" Gypsum Board

- Resilient Sound Isolation Clips (RSIC-1) shall be 48 inches maximum on center .
- Fasten the Resilient Sound Isolation Clip (RSIC-1) to the substrate with a fastener approved for a minimum pull-out and shear of 120 lbs.
- Ensure the internal metal ferrule is tight to the substrate.
- Locate the first row of RSIC-1 clips within 8 inches of the wall at each end of a run.
- Snap in the drywall furring channel (hat track) into the RSIC-1 clips.
- Install the gypsum board from leaving a 1/4" min. gap around the perimeter of the ceiling.
- Caulk around the entire perimeter of the gypsum board. Use fire and smoke rated acoustical sealant where required.



General Information:

- Refer to www.UL.com, or www.pac-intl.com for complete installation details on all fire resistive assembly designs.
- Resilient Sound Isolation Clip (RSIC-1), furring channel (hat track) and gypsum board shall not carry heavy loads such as cabinets or bookshelves
- Splice furring channel (hat track) with 6 inch overlap in mid span, secure with 18 ga. tie wire or with two framing screws (7/16")
- Seal all potential air leaks with non-hardening acoustical caulking to achieve best noise control results. Use fire rated sealant where required.
- When attaching the RSIC-1 clips to a steel stud the minimum allowable thickness is 20 ga. (0.030).

Fire Test Information:

Approved for use in over 150 different UL fire resistive design assemblies.

Check UL Fire Resistance Directory File # R16638 for PAC International.

Contact us with any questions about Fire Testing or Installation.



888-666-5090 www.soundisolationcompany.com sales@soundisolationcompany.com

RSIC® is a registered Trademark of PAC International, Inc.

JAMB EXTENSION DETAIL

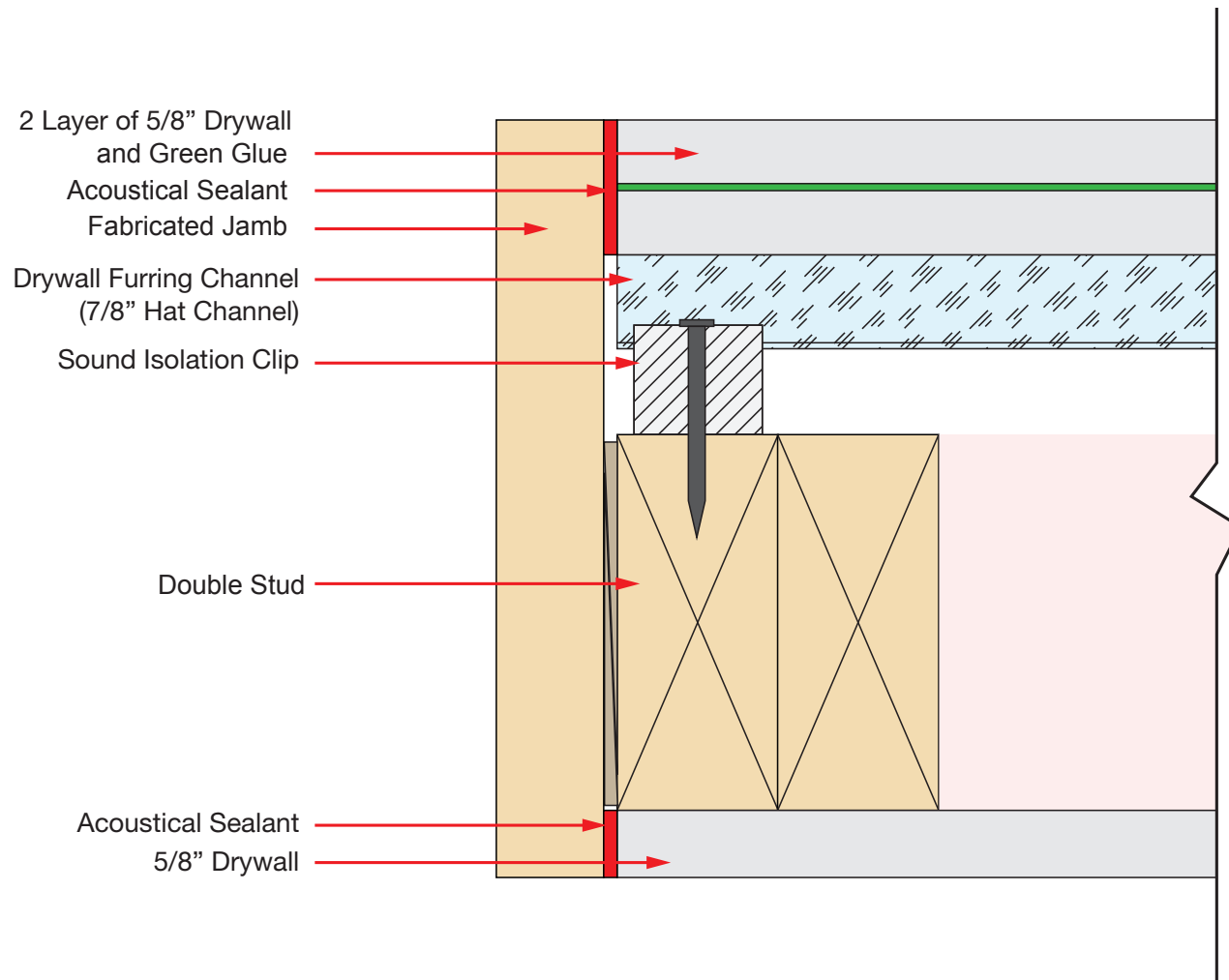

- Notes:
- 1) Fabricate door jams with 2 x material. Jamb width must cover all drywall layers- leave a small gap and fill with sealant.
 - 2) Channel should not intersect with jamb
 - 3) Door Trim should be attached to either jamb or drywall , NOT both

RSIC-1 SOUND ISOLATION CLIP

APPLICATION RECOMMENDATIONS FOR WALLS AND CEILINGS, WOOD OR STEEL FRAMING

INSTALLING RESILIENT SOUND ISOLATION CLIPS (RSIC-1)

RSIC CLIPS AT 24" OC.

RSIC-1 Wall or Ceiling System Framing at 24" o.c.

RSIC-1 clips at 24" x 48" o.c. 1 or 2 Layers of 5/8" Gypsum Board

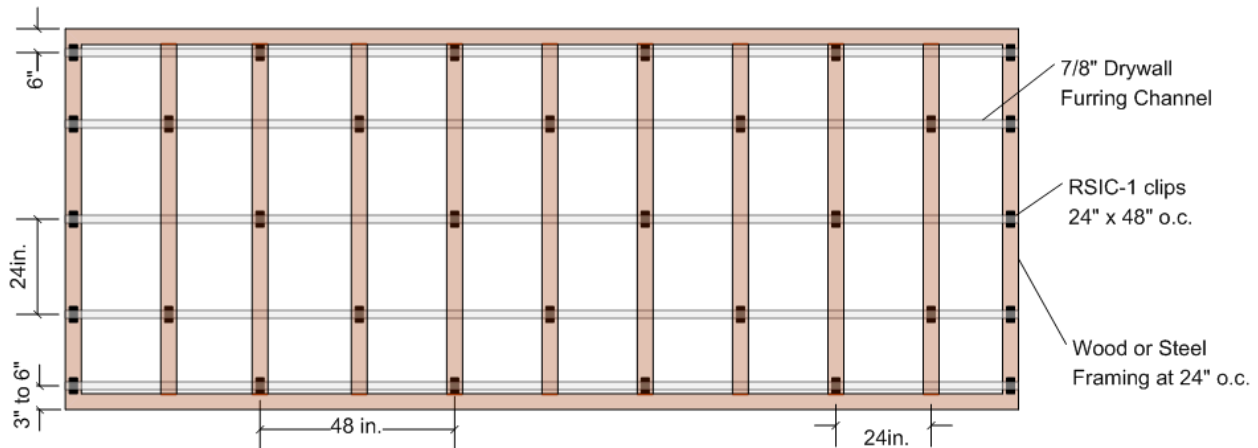

RSIC-1 Wall or Ceiling System Framing at 16" o.c.

RSIC-1 clips at 24" x 48" o.c. 1 or 2 Layers of 5/8" Gypsum Board

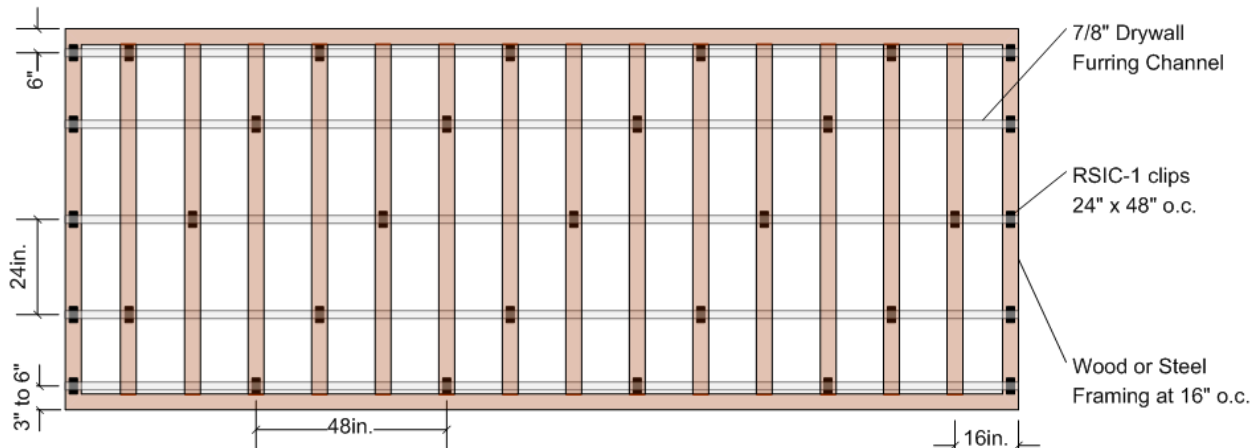

888-666-5090 www.soundisolationcompany.com sales@soundisolationcompany.com

RSIC® is a registered Trademark of PAC International, Inc.

RSIC-1 SOUND ISOLATION CLIP

APPLICATION RECOMMENDATIONS FOR WALLS AND CEILINGS, WOOD OR STEEL FRAMING

INSTALLING RESILIENT SOUND ISOLATION CLIPS (RSIC-1)

RSIC CLIPS AT 16" OC.

RSIC-1 Wall or Ceiling System Framing at 24" o.c.

RSIC-1 clips at 16" x 48" o.c. 3 Layers of 5/8" Gypsum Board

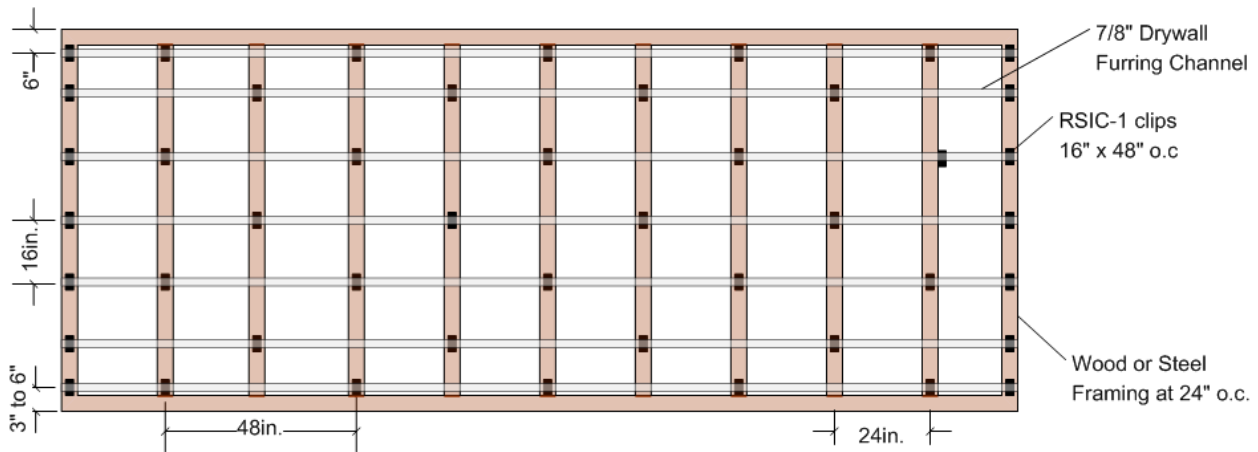

RSIC-1 Wall or Ceiling System Framing at 16" o.c.

RSIC-1 clips at 16" x 48" o.c. 3 Layers of 5/8" Gypsum Board

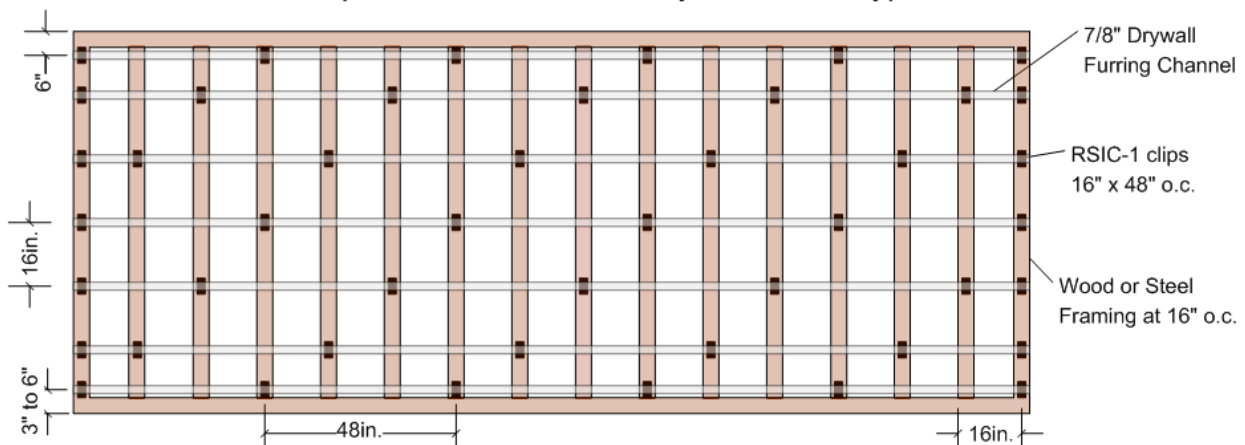

888-666-5090 www.soundisolationcompany.com sales@soundisolationcompany.com

RSIC® is a registered Trade Mark of PAC International, Inc.

RSIC-1 SOUND ISOLATION CLIP

**ESTIMATED RSIC CLIP USAGE FOR WALLS AND CEILINGS,
WOOD OR STEEL FRAMED. (SPACING AT 24" X 48" O.C.)**

| | 1~4' | 5~8 | 9~12 | 13~16 | 17~20 | 21~24 | 25~28 | 29~32 | 33~36 | 37~40 |
|-------|------|-----|------|-------|-------|-------|-------|-------|-------|-------|
| 1~3' | 4 | 6 | 8 | 10 | 12 | 14 | 16 | 18 | 20 | 22 |
| 3~5 | 6 | 9 | 12 | 15 | 18 | 21 | 24 | 27 | 30 | 33 |
| 5~7 | 8 | 12 | 16 | 20 | 24 | 28 | 32 | 36 | 40 | 44 |
| 7~9 | 10 | 15 | 20 | 25 | 30 | 35 | 40 | 45 | 50 | 55 |
| 9~11 | 12 | 18 | 24 | 30 | 36 | 42 | 48 | 54 | 60 | 66 |
| 11~13 | 14 | 21 | 28 | 35 | 42 | 49 | 56 | 63 | 70 | 77 |
| 13~15 | 16 | 24 | 32 | 40 | 48 | 56 | 64 | 72 | 80 | 88 |
| 15~17 | 18 | 27 | 36 | 45 | 54 | 63 | 72 | 81 | 90 | 99 |
| 17~19 | 20 | 30 | 40 | 50 | 60 | 70 | 80 | 90 | 100 | 110 |
| 19~21 | 22 | 33 | 44 | 55 | 66 | 77 | 88 | 99 | 110 | 121 |
| 21~23 | 24 | 36 | 48 | 60 | 72 | 84 | 96 | 108 | 120 | 132 |
| 23~25 | 26 | 39 | 52 | 65 | 78 | 91 | 104 | 117 | 130 | 143 |
| 25~27 | 28 | 42 | 56 | 70 | 84 | 98 | 112 | 126 | 140 | 154 |
| 27~29 | 30 | 45 | 60 | 75 | 90 | 105 | 120 | 135 | 150 | 165 |
| 29~31 | 32 | 48 | 64 | 80 | 96 | 112 | 128 | 144 | 160 | 176 |
| 31~33 | 34 | 51 | 68 | 85 | 102 | 119 | 136 | 153 | 170 | 187 |
| 33~35 | 36 | 54 | 72 | 90 | 108 | 126 | 144 | 162 | 180 | 198 |
| 35~37 | 38 | 57 | 76 | 95 | 114 | 133 | 152 | 171 | 190 | 209 |
| 37~39 | 40 | 60 | 80 | 100 | 120 | 140 | 160 | 180 | 200 | 220 |
| 39~41 | 42 | 63 | 84 | 105 | 126 | 147 | 168 | 189 | 210 | 231 |

Note: Add 4 RSIC-1 at each drywall butt joint condition for optimum acoustical and UL Fire Resistive assembly compliances. See UL Fire Resistive Design specifications.

888-666-5090 www.soundisolationcompany.com sales@soundisolationcompany.com

RSIC® is a registered Trade Mark of PAC International, Inc.

RSIC-1 SOUND ISOLATION CLIP

ESTIMATED RSIC CLIP USAGE FOR WALLS AND CEILINGS, WOOD OR STEEL FRAMED. (SPACING AT 16" X 48" O.C.)

| | 1~4 | 5~8 | 9~12 | 13~16 | 17~20 | 21~24 | 25~28 | 29~32 | 33~36 | 37~40 |
|------------|-----|-----|------|-------|-------|-------|-------|-------|-------|-------|
| 1~1.3' | 4 | 6 | 8 | 10 | 12 | 14 | 16 | 18 | 20 | 22 |
| 1.3~2.6' | 6 | 9 | 12 | 15 | 18 | 21 | 24 | 27 | 30 | 33 |
| 2.6~4' | 8 | 12 | 16 | 20 | 24 | 28 | 32 | 36 | 40 | 44 |
| 4~5.3' | 10 | 15 | 20 | 25 | 30 | 35 | 40 | 45 | 50 | 55 |
| 5.3~6.6' | 12 | 18 | 24 | 30 | 36 | 42 | 48 | 54 | 60 | 66 |
| 6.6~8' | 14 | 21 | 28 | 35 | 42 | 49 | 56 | 63 | 70 | 77 |
| 8~9.3' | 16 | 24 | 32 | 40 | 48 | 56 | 64 | 72 | 80 | 88 |
| 9.3~10.6' | 18 | 27 | 36 | 45 | 54 | 63 | 72 | 81 | 90 | 99 |
| 10.6~12' | 20 | 30 | 40 | 50 | 60 | 70 | 80 | 90 | 100 | 110 |
| 12~13.3' | 22 | 33 | 44 | 55 | 66 | 77 | 88 | 99 | 110 | 121 |
| 13.3~14.6' | 24 | 36 | 48 | 60 | 72 | 84 | 96 | 108 | 120 | 132 |
| 14.6~16' | 26 | 39 | 52 | 65 | 78 | 91 | 104 | 117 | 130 | 143 |
| 16~17.3' | 28 | 42 | 56 | 70 | 84 | 98 | 112 | 126 | 140 | 154 |
| 17.3~18.6' | 30 | 45 | 60 | 75 | 90 | 105 | 120 | 135 | 150 | 165 |
| 18.6~20' | 32 | 48 | 64 | 80 | 96 | 112 | 128 | 144 | 160 | 176 |
| 20~21.3' | 34 | 51 | 68 | 85 | 102 | 119 | 136 | 153 | 170 | 187 |
| 21.3~22.6' | 36 | 54 | 72 | 90 | 108 | 126 | 144 | 162 | 180 | 198 |
| 22.6~24' | 38 | 57 | 76 | 95 | 114 | 133 | 152 | 171 | 190 | 209 |
| 24~25.3' | 40 | 60 | 80 | 100 | 120 | 140 | 160 | 180 | 200 | 220 |
| 25.3~26.6' | 42 | 63 | 84 | 105 | 126 | 147 | 168 | 189 | 210 | 231 |
| 26.6~28' | 44 | 66 | 88 | 110 | 132 | 154 | 176 | 198 | 220 | 242 |
| 28~29.3' | 46 | 69 | 92 | 115 | 138 | 161 | 184 | 207 | 230 | 253 |
| 29.3~30.6' | 48 | 72 | 96 | 120 | 144 | 168 | 192 | 216 | 240 | 264 |
| 30.6~32' | 50 | 75 | 100 | 125 | 150 | 175 | 200 | 225 | 250 | 275 |
| 32~33.3 | 52 | 78 | 104 | 130 | 156 | 182 | 208 | 234 | 260 | 286 |
| 33.3~34.6' | 54 | 81 | 108 | 135 | 162 | 189 | 216 | 243 | 270 | 297 |
| 34.6~36' | 56 | 84 | 112 | 140 | 168 | 196 | 224 | 252 | 280 | 308 |
| 36~37.3 | 58 | 87 | 116 | 145 | 174 | 203 | 232 | 261 | 290 | 319 |
| 38.6~40' | 60 | 90 | 120 | 150 | 180 | 210 | 240 | 270 | 300 | 330 |
| 40~41.3' | 62 | 93 | 124 | 155 | 186 | 217 | 248 | 279 | 310 | 341 |

Note: Add 4 RSIC-1 at each drywall butt joint condition for optimum acoustical and UL Fire Resistive assembly compliances. See UL Fire Resistive Design specifications.

888-666-5090 www.soundisolationcompany.com sales@soundisolationcompany.com

RSIC® is a registered Trade Mark of PAC International, Inc.

RSIC-1 SOUND ISOLATION CLIP



The RSIC-1 is the first and only product classified by UL for both fire and sound.

Members of the International Code Council

WARRANTY DISCLAIMER AND LIABILITY LIMITATION LANGUAGE

NO EXPRESS OR IMPLIED WARRANTIES

THERE IS NO WARRANTY, REPRESENTATION OR CONDITION OF ANY KIND; AND ANY WARRANTY, EXPRESS OR IMPLIED, IS EXCLUDED AND DISCLAIMED, INCLUDING THE IMPLIED WARRANTIES OF MERCHANTABILITY AND OF FITNESS FOR A PARTICULAR PURPOSE. Some states do not allow limitations on implied warranties, so the above limitation may not apply to you.

LIABILITY LIMITED TO RETURN OF PURCHASE PRICE

IT IS AGREED THAT SELLER'S LIABILITY AND PURCHASER'S SOLE REMEDY, WHETHER IN CONTRACT, UNDER ANY WARRANTY, IN TORT (INCLUDING NEGLIGENCE), IN STRICT LIABILITY OR OTHERWISE, SHALL NOT EXCEED THE RETURN OF THE AMOUNT OF THE PURCHASE PRICE PAID BY PURCHASER, AND UNDER NO CIRCUMSTANCES SHALL SELLER BE LIABLE FOR ANY SPECIAL, INCIDENTAL OR CONSEQUENTIAL DAMAGES, INCLUDING, BUT NOT LIMITED TO, PERSONAL INJURY, PROPERTY DAMAGE, DAMAGE TO OR LOSS OF EQUIPMENT, LOST PROFITS OR REVENUE, COSTS OF RENTING REPLACEMENTS AND OTHER ADDITIONAL EXPENSES, EVEN IF SELLER HAS BEEN ADVISED OF THE POSSIBILITY OF SUCH DAMAGES. THE PRICE STATED FOR THE EQUIPMENT IS A CONSIDERATION IN LIMITING SELLER'S LIABILITY AND PURCHASER'S REMEDY. Some states do not allow the exclusion or limitation of incidental or consequential damages, so the above limitation or exclusion may not apply to you.

SELLER NOT LIABLE FOR PURCHASER'S NEGLIGENCE

SELLER WILL NOT BE LIABLE FOR ANY DAMAGES, LOSSES OR EXPENSES AS A RESULT OF PURCHASER'S NEGLIGENCE, WHETHER DEEMED ACTIVE OR PASSIVE AND WHETHER OR NOT ANY SUCH NEGLIGENCE IS THE SOLE CAUSE OF ANY SUCH DAMAGE, LOSS OR EXPENSE.

MODEL FOR DEMONSTRATION PURPOSES ONLY

THE MODEL OR SAMPLE SHOWN BY SELLER TO BUYER IS USED FOR DEMONSTRATION PURPOSES ONLY. THERE IS NO WARRANTY THAT THE GOODS AS DELIVERED SHALL CONFORM TO THE MODEL OR SAMPLE, AND CONFORMITY OF THE GOODS TO THE MODEL OR SAMPLE IS NOT PART OF THE BASIS OF THE BARGAIN BETWEEN SELLER AND BUYER.

NO WARRANTY OR COMPLIANCE WITH SAFETY CODE OR REGULATION

SELLER DOES NOT WARRANT THAT ANY OF THE GOODS SOLD WILL MEET OR COMPLY WITH THE REQUIREMENTS OF ANY SAFETY CODE, BUILDING OR DWELLING CODE, OR REGULATION OF ANY STATE, MUNICIPALITY OR OTHER JURISDICTION.

NEVADA LAW APPLIES

SELLER AND BUYER AGREE THAT ALL ASPECTS OF THIS TRANSACTION INCLUDING THE APPLICABLE STATUTE OF LIMITATIONS SHALL BE GOVERNED BY THE INTERNAL LAW OF THE STATE OF OREGON, AND NOT THE LAWS OF CONFLICTS. This warranty gives you specific legal rights, and you may also have other rights which vary from state to state.

888-666-5090 www.soundisolationcompany.com sales@soundisolationcompany.com

RSIC® is a registered Trade Mark of PAC International, Inc.